

MOUNT SCHOENSTATT SPIRITUALITY CENTRE

ABN 43 317 574 989

230 Fairlight Road

Mulgoa NSW 2745

Phone: 4773 8338

Fax: 4773 8530

E-mail: info@schoenstatt.org.au

The Home of Light Risk Assessment



The Home of Light at Mount Schoenstatt Spirituality Centre

Email: info@schoenstatt.org.au
Website: www.schoenstatt.org.au

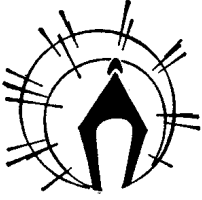

MOUNT SCHOENSTATT SPIRITUALITY CENTRE

ABN 43 317 574 989

230 Fairlight Road

Mulgoa NSW 2745

Phone: 4773 8338

Fax: 4773 8530

E-mail: info@schoenstatt.org.au

Floor Plan

FLOOR PLAN FOR THE HOME OF LIGHT, MSSC

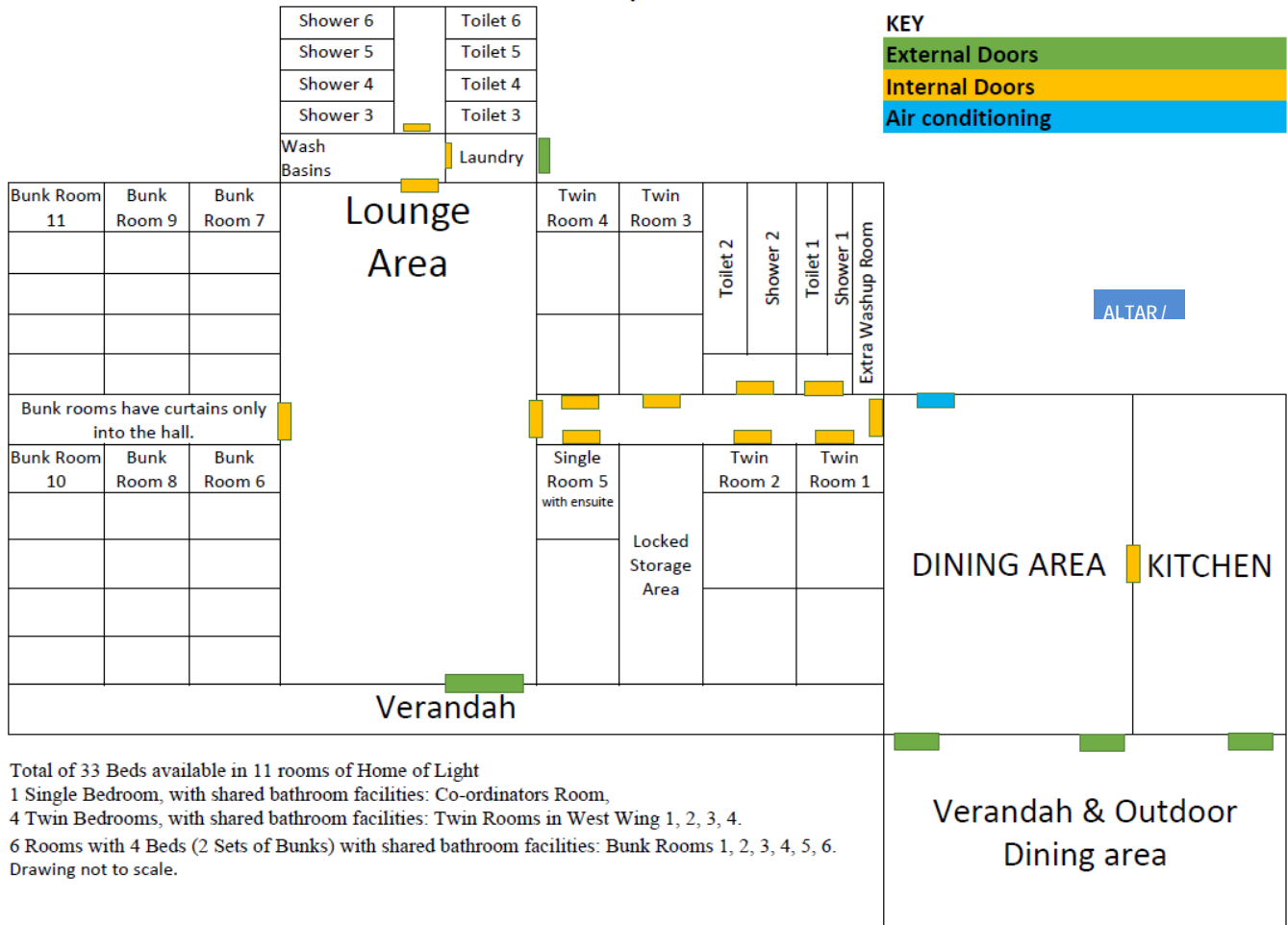

Total of 33 Beds available in 11 rooms of Home of Light

1 Single Bedroom, with shared bathroom facilities: Co-ordinators Room,

4 Twin Bedrooms, with shared bathroom facilities: Twin Rooms in West Wing 1, 2, 3, 4.

6 Rooms with 4 Beds (2 Sets of Bunks) with shared bathroom facilities: Bunk Rooms 1, 2, 3, 4, 5, 6.

Drawing not to scale.

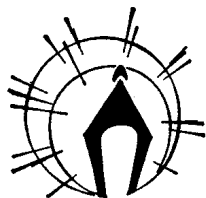

MOUNT SCHOENSTATT SPIRITUALITY CENTRE

ABN 43 317 574 989

230 Fairlight Road

Mulgoa NSW 2745

Phone: 4773 8338

Fax: 4773 8530

E-mail: info@schoenstatt.org.au

Emergencies

The main administration office in Joseph Kantenich House can be contacted from the Home of Light, via the internal phone in the kitchen, but all groups hiring the facility should bring mobile phones to use in case of an emergency. The Mount Schoenstatt Spirituality Centre telephone number is 4773 8338 and the address is 230 Fairlight Road, with the nearest cross street being Henry Cox Drive. The Home of Light is located in the valley, go past the main building (Joseph Kantenich House) and follow the road left and down into the valley to gain access.

Emergency numbers

Police/Fire Brigade/Ambulance

000

Local rural fire service

47738011

Penrith Police

47219444

See your booking confirmation for in-house emergency contact numbers during your stay.

Fire Safety

The bush location of the Home of Light means it is bushfire prone. No smoking is allowed in the Home of Light, and please do not smoke in or near the bush, extreme caution must always be used but particularly during the warmer months.

NO FIRES ARE PERMITTED ON THE GROUNDS OF MSSC

Fire Equipment

The facility is equipped with required fire extinguishing equipment. There is a fire blanket and an all-purpose extinguisher in the kitchen. The group coordinator should familiarise themselves with the location and operation of the equipment. This equipment is for internal fires and is not meant to be used for external bush fires. We recommend that if there is even the slightest threat of fire, your group should leave the premises and return at a safer time. (If you decide to evacuate, please let someone in the main house know) 02 4773 8338. If an evacuation alert is received, you will be notified immediately.

Email: info@schoenstatt.org.au

Website: www.schoenstatt.org.au

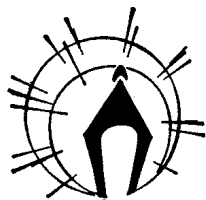

MOUNT SCHOENSTATT SPIRITUALITY CENTRE

ABN 43 317 574 989

230 Fairlight Road

Mulgoa NSW 2745

Phone: 4773 8338

Fax: 4773 8530

E-mail: info@schoenstatt.org.au

Safety in the Bush

All visitors are asked to enjoy the bushland setting but to be mindful that it is also the natural habitat of a number of species, including snakes and spiders.

Children should be supervised at all times, if playing in the bush and should wear covered in shoes for safety. Everyone needs to remain on paths in cleared areas and avoid walking in areas with dense undergrowth.

The kangaroos on site live in harmony with the Sisters and visitors but remember they are not domestic animals and could become defensive if approached, especially during the breeding season. Please do not chase the kangaroos.

First Aid

Whilst a first aid kit is provided, we recommend that all groups bring a fully stock first aid kit with them. We also recommend that a responsible adult is put in charge of first aid and is aware of the contents of all kits.

MOUNT SCHOENSTATT HOME OF LIGHT RISK ASSESSMENT			
Name of School/Group		Name of Excursion Coordinator	
HAZARD IDENTIFICATION	RISK ASSESSMENT	ELIMINATION OR CONTROL MEASURES	BY WHOM
No direct outside telephone line available in case of emergencies	Medium	<ul style="list-style-type: none">Group organiser brings mobile phoneContact Mt Schoenstatt using extension phone in kitchen	Teacher in Charge/Group Coordinator
Walking around site, injuries to feet from sticks, stones	Medium	<ul style="list-style-type: none">Ensure students/children wear covered in shoes when playing outside	Teacher in Charge/Group coordinator
Walking in Bush, possibility of stings and bites from insects, spiders, snakes etc	Medium	<ul style="list-style-type: none">Adults/children advised of presence of snakes/spiders/insects etcRemain in cleared areas and established tracksWear covered in shoe, cover arms and legs where possibleEnsure first aid kit includes insect repellent and first aid advice	Teacher in Charge/ Group Coordinator Groups to bring a fully equipped first aid kit

Email: info@schoenstatt.org.au

Website: www.schoenstatt.org.au

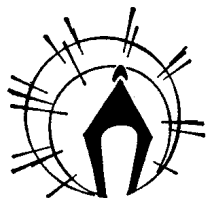

MOUNT SCHOENSTATT SPIRITUALITY CENTRE

ABN 43 317 574 989

230 Fairlight Road

Mulgoa NSW 2745

Phone: 4773 8338

Fax: 4773 8530

E-mail: info@schoenstatt.org.au

Name of School/Group		Name of Excursion Coordinator	
Burns from Zip, Urns, Toaster & Stove in kitchen	Medium	<ul style="list-style-type: none"> Adults to operate equipment Ensure First Aid Kit is available 	Groups to bring a fully equipped first aid kit
Burns from Stove/Oven	Medium	<ul style="list-style-type: none"> Adults to operate equipment Ensure First Aid Kit is available 	Mt Schoenstatt Staff All Hirers
Fire inside building and outdoors	Medium	<ul style="list-style-type: none"> No smoking or use of candles inside building Extreme care taken if smoking outside Sign no fires outdoors, no BBQ in picnic area Fire equipment, Fire drills, fire exit plan 	Mt Schoenstatt Staff All hirers
Tripping hazard from microphone cord	Medium	<ul style="list-style-type: none"> Ensure cord is placed as close to outlet as possible 	Mt Schoenstatt Staff All Hirers

RISK ASSESSMENT MATRIX

LIKELIHOOD OF OCCURRENCE	EXTENT OF INJURY	VERY LIKELY	LIKELY	UNLIKELY	HIGHLY UNLIKELY
	FATALITY	HIGH	HIGH	HIGH	MEDIUM
	MAJOR INJURY	HIGH	HIGH	MEDIUM	MEDIUM
	MINOR INJURY	HIGH	MEDIUM	MEDIUM	LOW
	NEGLIGIBLE INJURY	MEDIUM	MEDIUM	LOW	LOW

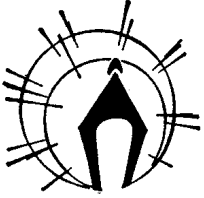

MOUNT SCHOENSTATT SPIRITUALITY CENTRE

ABN 43 317 574 989

230 Fairlight Road

Mulgoa NSW 2745

Phone: 4773 8338

Fax: 4773 8530

E-mail: info@schoenstatt.org.au

Email: info@schoenstatt.org.au
Website: www.schoenstatt.org.au